

# MC5590

## Quick Start Guide

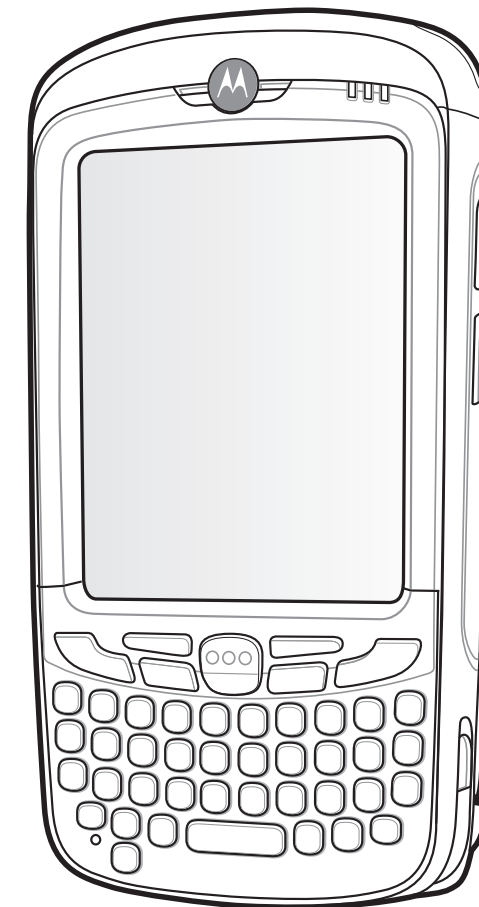

### FEATURES

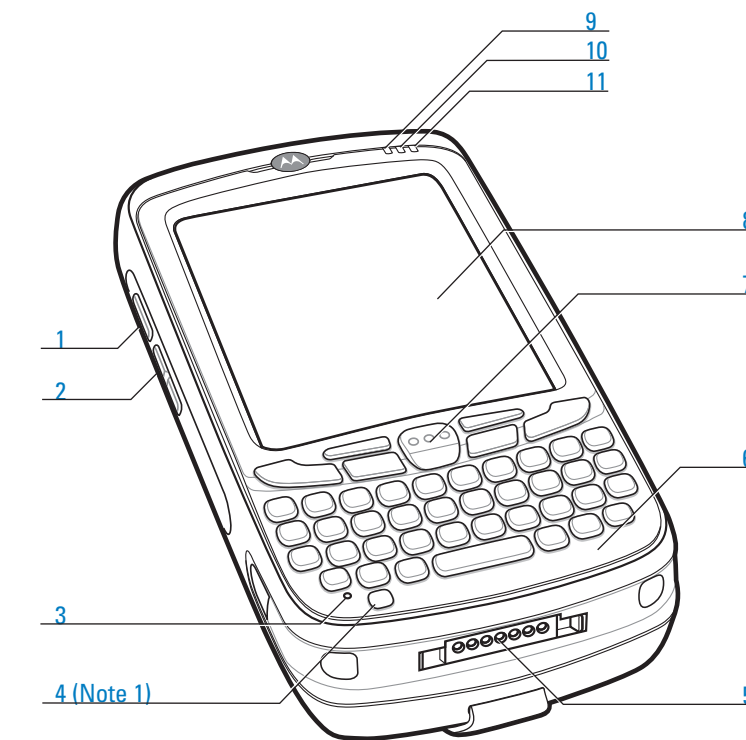

- |                         |  |                                |
|-------------------------|--|--------------------------------|
| 1 Scan/Action Button    | 5 I/O Connector                        | 9 Scan/Decode LED              |
| 2 Volume Up/Down Button | 6 Keypad                               | 10 Charging/Battery Status LED |
| 3 Microphone            | 7 Scan/Action Button                   | 11 Not Used                    |
| 4 Power Button          | 8 Touch Screen (with screen protector) |                                |

Note 1: To reset the MC55, press and hold the Power button for five (5) seconds.

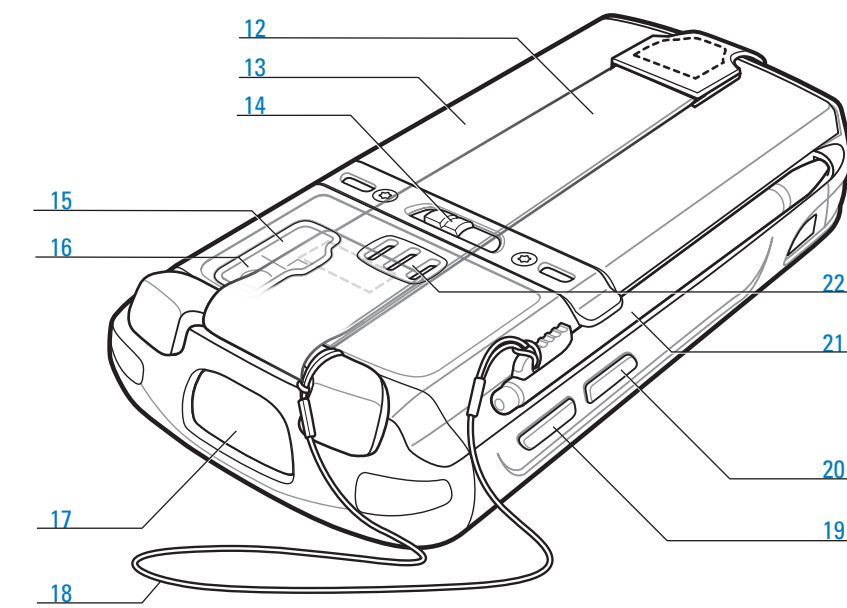

- |   |                       |
|---|-----------------------|
| 12 Handstrap                              | 18 Tether             |
| 13 Battery                                | 19 Scan/Action Button |
| 14 Battery Latch                          | 20 Action Button      |
| 15 Camera Flash                           | 21 Stylus             |
| 16 Camera                                 | 22 Speaker            |
| 17 Scan Window (see Data Capture Options) |                       |

### Notifications

#### Scan/Decode LED:

- Red: Scanning active
- Green: Good Decode

#### Charging/Battery Status LED:

- Slow blinking amber: Battery charging
- Solid amber: Fully charged
- Fast blinking amber: Charging error

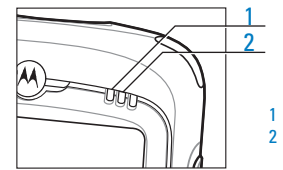

- |                           |
|---------------------------|
| 1 Scan/Decode             |
| 2 Charging/Battery Status |

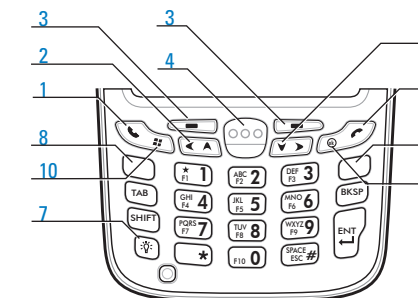

#### Numeric Keypad

#### Blue Key

Use this key to access function keys shown on the keypad in blue.  
 > Press the Blue key once to activate this state, followed by another key.

#### Orange Key

Use this key to access the secondary layer of characters.  
 > Press the Orange key once to lock the keypad into Alpha state.  
 > Press the Orange key a second time to return to the normal state.

- |                      |
|----------------------|
| 1 Talk               |
| 2 Navigation         |
| 3 Soft Key           |
| 4 Scan/Action Button |
| 5 End                |
| 6 Orange Key         |
| 7 Backlight          |
| 8 Blue Key           |
| 9 OK                 |
| 10 Start Menu        |

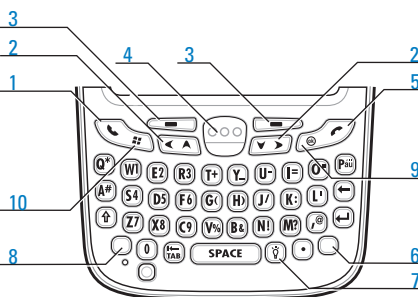

#### Alpha-Numeric Keypad

#### Blue Key

Use this key to access function keys shown on the keypad in blue.  
 > Press the Blue key once to activate this state temporarily, followed by another key.  
 > Press the Blue key twice to lock this state.  
 > Press the Blue key a third time to unlock.

#### Orange Key

Use this key to access the secondary layer of characters and actions.  
 > Press the Orange key once to activate this state temporarily, followed by another key.  
 > Press the Orange key twice to lock this state.  
 > Press the Orange key a third time to unlock.

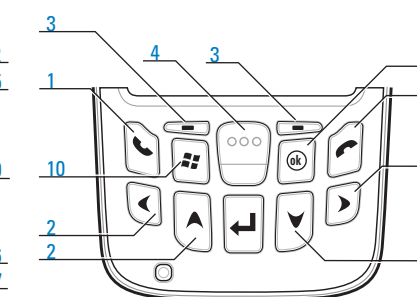

#### PIM Keypad

## GETTING STARTED - BATTERY INSTALLATION

### Insert the Battery

1. Insert the battery, bottom first, into the battery compartment.
2. Press down on the battery until the battery latch snaps into place.

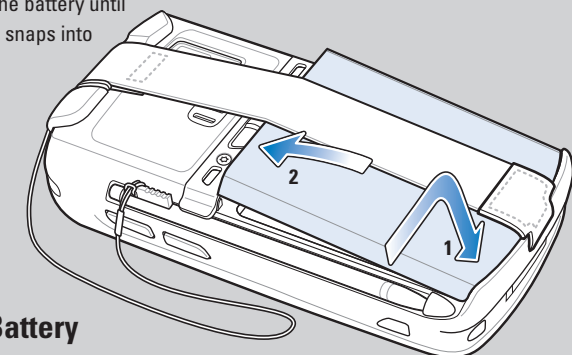

### Remove the Battery

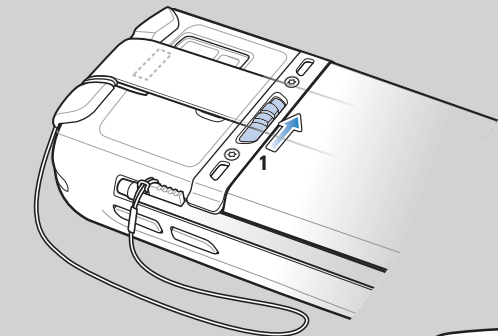

1. Slide battery latch to the right. The battery ejects slightly.
2. Grasp the battery and lift from the MC55.

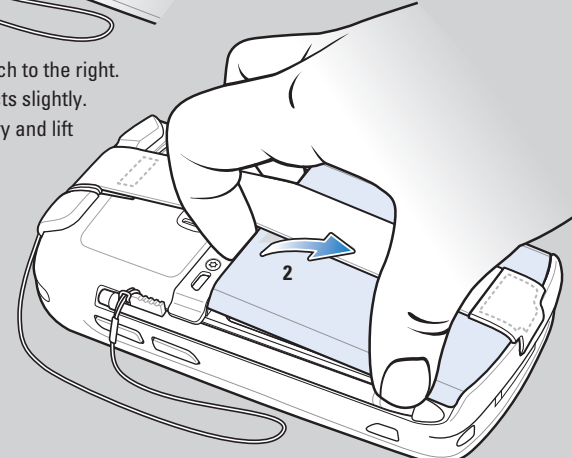

### Charge the MC55

Use the Single-slot USB cradle or a Four-slot cradles to charge the battery in the MC55.

You can also charge a spare battery using the Single-slot cradle.

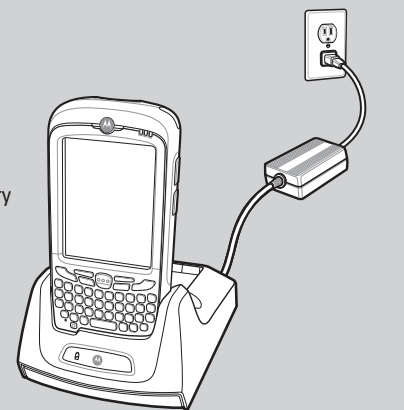

- Charging/Battery Status LED
- Slow Blinking Amber = Charging
- Solid Amber = Fully charged
- Fast Blinking Amber = Charging error

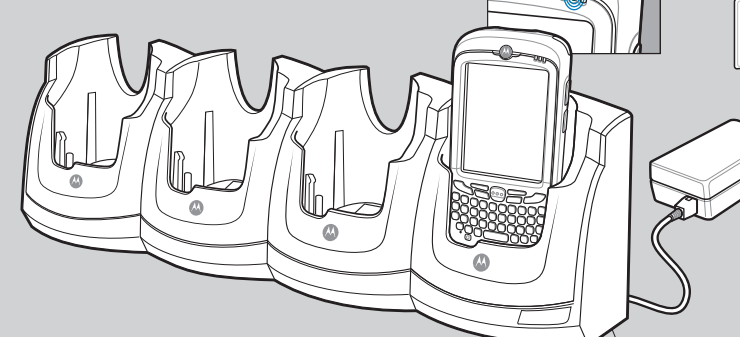

### Charge the Battery

Use the Four-slot Battery Charger to charge batteries separately.

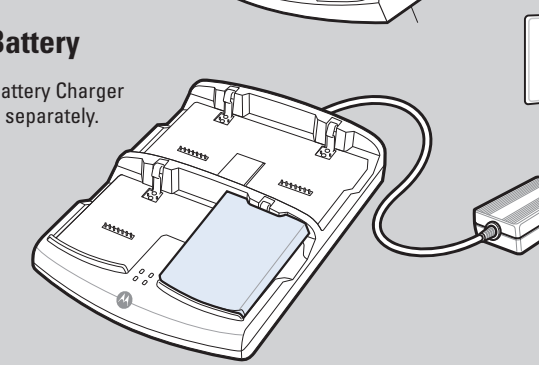

Note: The 2200 mAh battery charges in less than four hours and the 3600 mAh battery charges in less than six hours.

## COMMUNICATION

### Install Microsoft® ActiveSync®

Install ActiveSync to communicate with a host computer. Download ActiveSync® 4.5 or higher from <http://www.microsoft.com> and follow the instructions to install ActiveSync onto the host computer.

### Connect to Host Computer

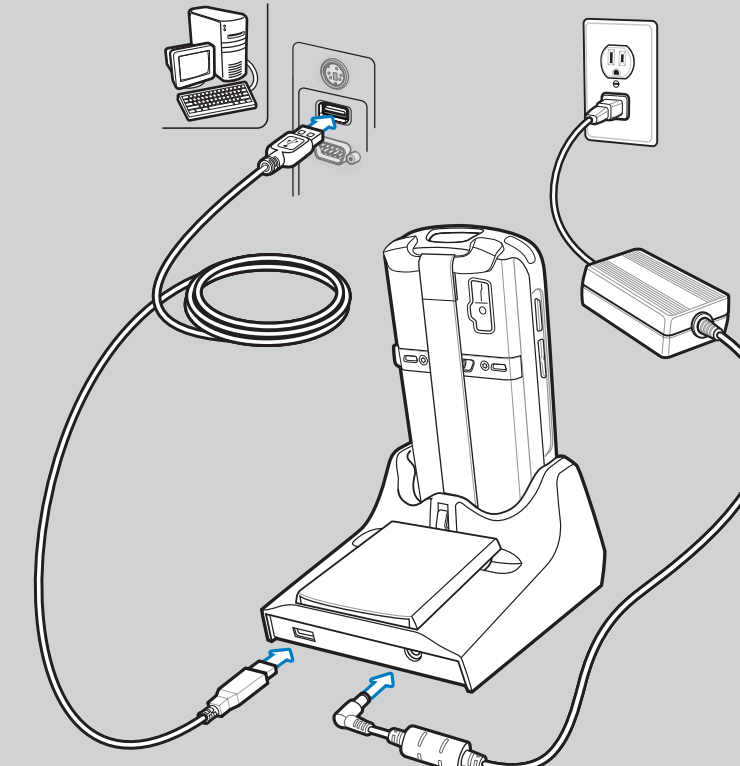

### Create a Partnership

Follow the on-screen ActiveSync instructions to establish a connection between the MC55 and the host computer.

## More Information on the MC55

Visit the Motorola Web site at <http://www.motorola.com/mc55>

## Setting up, using and troubleshooting the MC55

MC55 User Guide and Integrator Guide

Software Upgrades

Available at: <http://www.motorola.com/enterprisemobility/support>

## Additional Software

Check Motorola web site for approved applications.

<http://www.motorola.com/mc55>

## Connecting and synchronizing with the host computer

ActiveSync® Help on the host computer. To view help, start ActiveSync®,

Click Help - Microsoft ActiveSync Help.

ActiveSync software available at <http://www.microsoft.com>

Information on using programs on the MC55

Tap **Start** – **Help** within the specific program.

## Service and Warranty

MC55 Regulatory Guide

Available with MC55 and at <http://www.motorola.com/enterprisemobility/manuals>



**MOTOROLA**

Motorola, Inc.  
One Motorola Plaza Holtsville, New York 11742-1300, USA  
MOTOROLA and the Stylized M Logo and Symbol and the Symbol logo are registered in the U.S. Patent and Trademark Office. All other product or service names are the property of their respective owners. © Motorola, Inc. 2008



72-108862-01 Rev. A — September 2008

ACCESSORIES

## Screen Protector

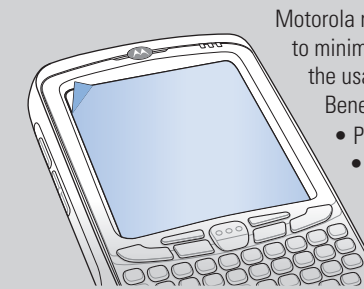

Motorola recommends the continued use of a screen protector to minimize wear and tear. Screen protectors enhance the usability and durability of touch screen displays.

Benefits include:

- Protection from scratches and gouges
- Durable writing and touch surface with tactile feel
- Abrasion and chemical resistance
- Glare reduction
- Keeping the device's screen looking like new
- Quick and easy installation.

Not using a screen protector can affect your warranty coverage.

An initial screen protector is already applied to your MC55.

Contact your local account manager or Motorola, Inc. for more information and purchasing details. Part number: KT-67525-01R Screen Protector 3/pk.

## MicroSD Card Installation

1. Remove battery.
2. Lift rubber access door.
3. Slide SIM card holder up to unlock.
4. Lift SIM card holder.
5. Carefully lift microSD card holder.
6. Insert microSD card into card holder.

microSD Card Holder

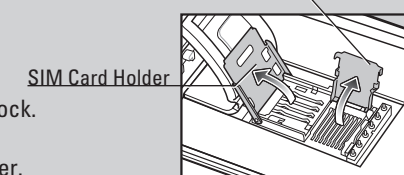

Rubber Access Door

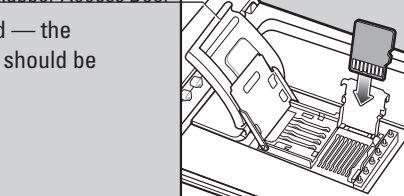

**NOTE:**

Proper position of the microSD card — the card connector (i.e., gold contacts) should be facing out as shown.

6. Close the microSD card holder.
7. Close the SIM card holder.
8. Slide the SIM card holder down to lock into place.
9. Close rubber access door.
10. Replace battery.

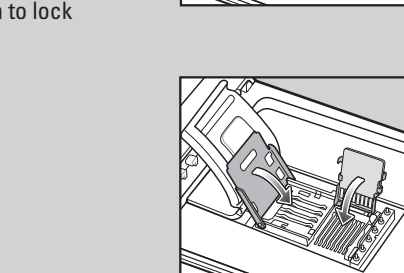

## Single-slot USB Cradle

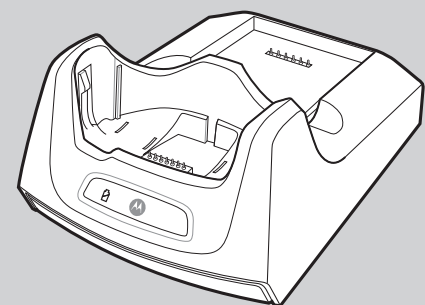

## Four-slot Battery Charger

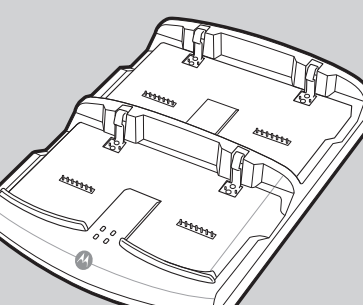

## Charger Only Cable



## USB/Charge Cable

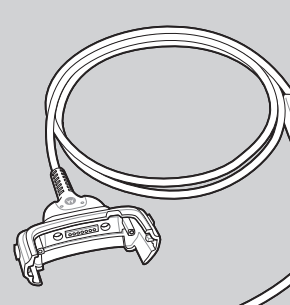

## Four-slot Charge Only Cradle

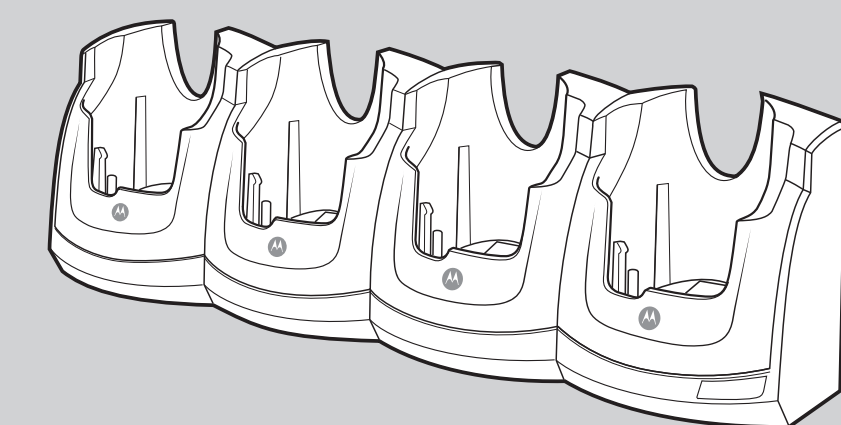

## Auto Charge Cable

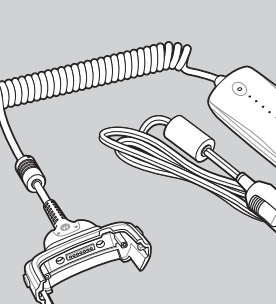

## Vehicle Holder

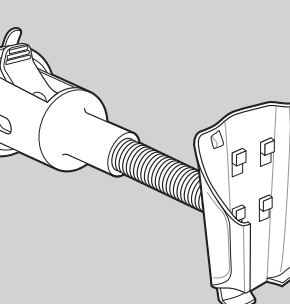

DATA CAPTURE OPTIONS

## Imaging

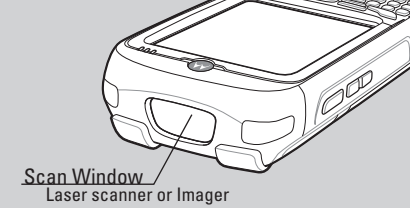

Scan Window  
Laser scanner or Imager

## Laser Scanning

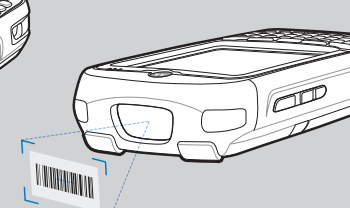

## Camera Decode

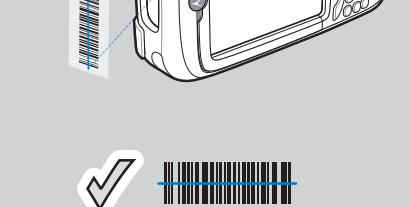
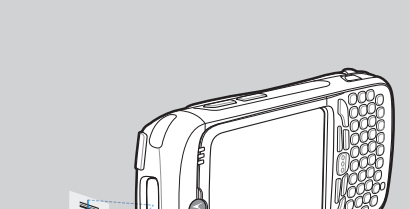
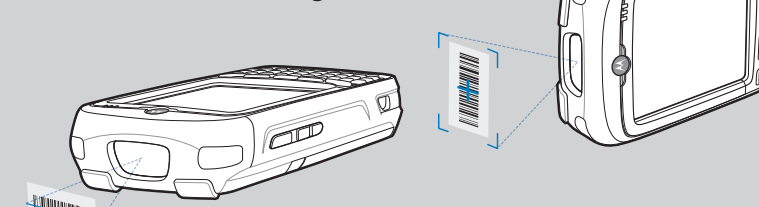

## Camera Photo

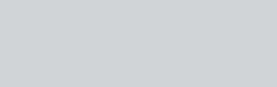
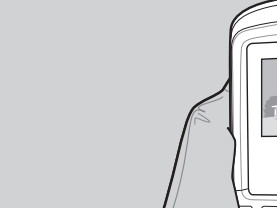
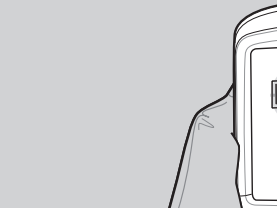

## Camera Decode

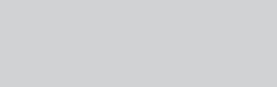
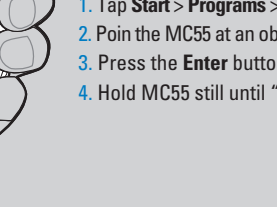
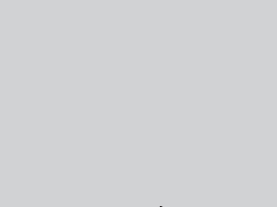
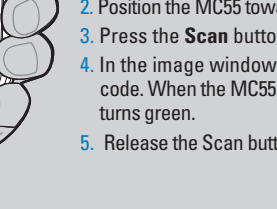

1. Launch a bar code reading application on the MC55.
2. Position the MC55 toward the bar code.
3. Press the **Scan** button.
4. In the image window align the red target over the bar code. When the MC55 decodes the bar code the target turns green.
5. Release the Scan button.

1. Tap **Start** > **Programs** > **Pictures & Videos** > **Camera**.
2. Point the MC55 at an object.
3. Press the **Enter** button.
4. Hold MC55 still until "Shutter Sound" is heard.

AVOID EXTREME WRIST ANGLES

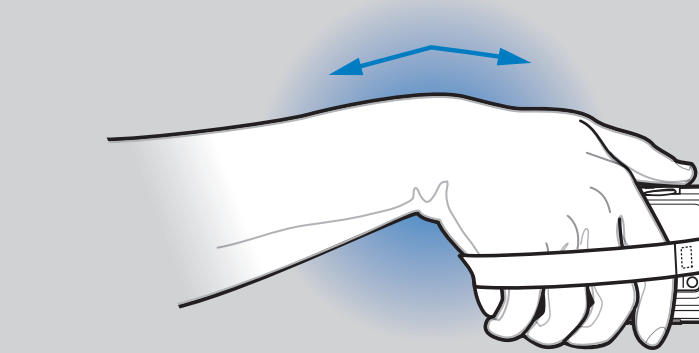
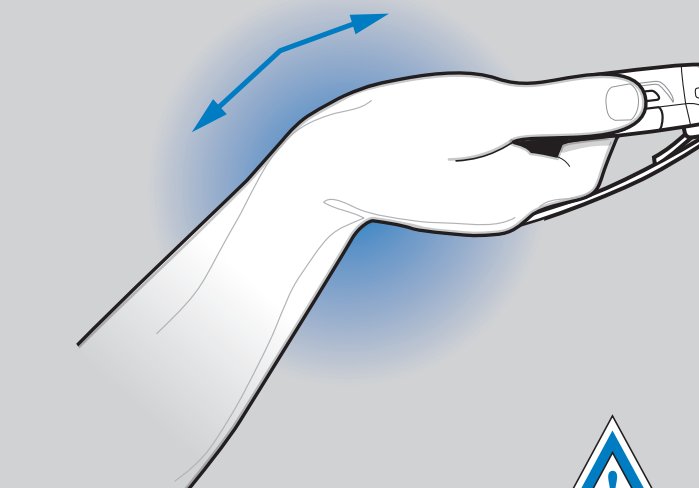

<http://www.motorola.com/MC55>